

PERMIT

CITY OF NAPOLEON, OHIO — DEPT. OF BUILDING & ZONING
255 W. Riverview Avenue, Napoleon, Ohio 43545 (419) 592-4010

Permit No. 0906 Date Sept. 17, 1984
Job Location 314 E. Clinton Valuation \$ _____
Owner Marvin Drummond Address 314 E. Clinton
Contractor Bostelman Electric Name _____ Address _____
Address 232 Rohrs Telephone No. 599-3416
Electric Contractor _____
Plumbing Contractor _____
Mechanical Contractor _____

This permit is issued for work described in the plans, specifications, and/or application submitted, as approved by the Building Commissioner of the City of Napoleon, Ohio. Work shall conform to all pertinent construction and land use Codes and Ordinances.

Work Information:
Residential Commercial _____ Industrial _____
New Construction _____ Addition _____ Remodel _____
Brief Description of Work Upgrade entrance

ISSUED BY Richard J. Gayman Building Official DEPT. OF BUILDING & ZONING

It is the owners or contractors responsibility to call the Building Department for the following (x) inspections:

- _____ Footing excavation prior to placing concrete.
- _____ Footing drains and foundation prior to backfill.
- _____ Prepared sub-grade prior to placing concrete floor slab.
- _____ Sanitary sewer
- Rough-in electrical, plumbing and service framing prior to installing wall board.
- Final electrical, plumbing and heating.
- _____ Final building inspection, prior to occupancy.

PERMIT & FEES

Building Permit	\$ _____
Electrical Permit	\$ <u>5.00</u>
Plumbing Permit	\$ _____
Mechanical Permit	\$ _____
Demolition Permit	\$ _____
Zoning Permit	\$ _____
Sign Permit	\$ _____
Water Tap	\$ _____
Sewer Tap	\$ _____
Temp. Elec.	\$ _____
Other	\$ _____
TOTAL FEES	\$ <u>5.00</u>
LESS FEES PAID	\$ <u>-0-</u>
BALANCE DUE	\$ <u>5.00</u>

PAID
SEP 17 1984
CITY OF NAPOLEON

Permit is not valid until all fees are paid in full, and shall be void if work is not started within six months of date above.

CITY OF NAPOLEON
BUILDING INSPECTION DEPARTMENT
APPLICATION FOR ELECTRICAL PERMIT
(Please print or type)

The undersigned hereby makes application for installation or replacement of electrical equipment as herein specified, agreeing to do all such work in strict accordance with the City of Napoleon's adopted Electrical Codes.

Owner's Name Martin Drummond Address 314 E. Clinton

Electrical Contractor Boatman Electric Telephone No. 599-3416

Address 232 Pobra

General Contractor _____ Telephone No. _____

Address _____

Location of Project _____ Cost of Project _____

Work Information:

Residential 2 Commercial _____ Industrial _____

No. Units _____
New _____ Service Change X Rewiring _____ Additional Wiring None

Brief Description of Work: up grade entrance

Size of proposed service entrance 100 Number of new circuits None

Type of proposed service entrance _____ Underground _____ Overhead X

Require Temporary Electric No (Yes or No)

Total Floor Area - Commercial and Industrial, only _____ sq. ft.

Additional Information: _____

*Ground fault circuit interrupter protection is required on all 120-volt single phase, 15 and 20 amp. Circuits which are part of a temporary electric service: and also on bathroom, outdoor, and garage receptacles in all dwelling units. Art. 210-8 N.E.C.

*Application for permit shall be accompanied by two complete sets of plans including: Electrical layout and riser diagram. (For commercial and industrial work only).

Date _____ Applicant's Signature Norman Boatman

PERMIT NO. 906
PERMIT FEE \$ 5.00



314 East Clinton St.

Foundation will be 36 in deep
16" wide, with 8 in. of concrete.
Then there will be 4 courses of
8 in Block.

Floor will be 6 in thick

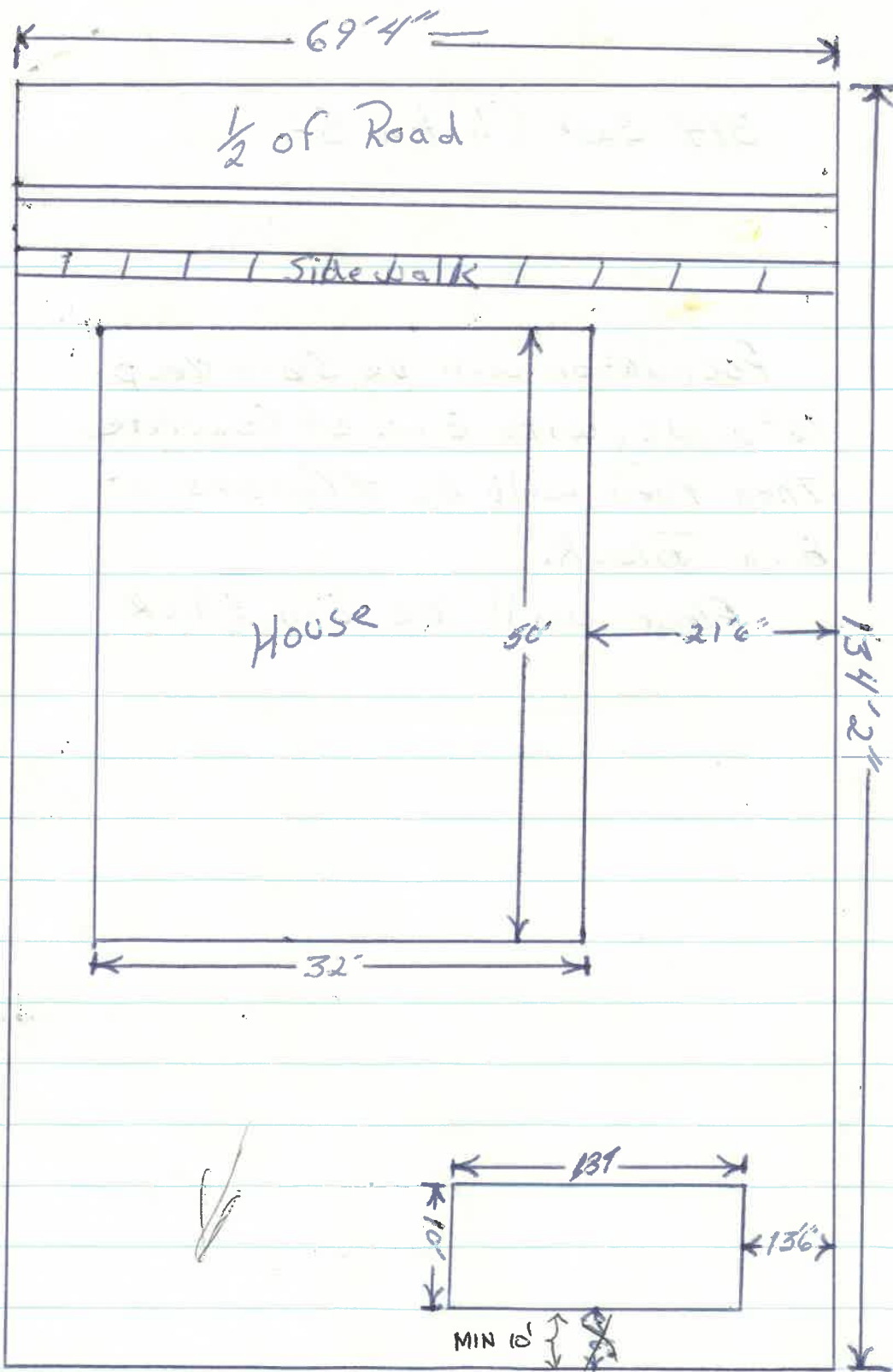

314 East Clinton St.

Foundation will be 36 in deep
16" wide, with 8 in. of concrete.
Then there will be 4 courses of
8 in Block.

Floor will be 6 in thick.

PERMIT

CITY OF NAPOLEON, OHIO — DEPT. OF BUILDING & ZONING
255 W. Riverview Avenue, Napoleon, Ohio 43545 (419) 592-4010

Permit No. 2900 Date Sept. 17, 1984
Job Location 314 E. Clinton Valuation \$ _____
Owner Harvin Drummond Address 314 E. Clinton
Contractor Bostelman Electric Name _____ Address _____ Telephone No. 599-3416
Address 232 Rohrs

Electric Contractor _____
Plumbing Contractor _____
Mechanical Contractor _____

This permit is issued for work described in the plans, specifications, and/or application submitted, as approved by the Building Commissioner of the City of Napoleon, Ohio. Work shall conform to all pertinent construction and land use Codes and Ordinances.

Work Information:

Residential X Commercial _____ Industrial _____
New Construction _____ Addition _____ Remodel _____
Brief Description of Work Upgrade entrance

ISSUED BY _____ DEPT. OF BUILDING & ZONING

It is the owners or contractors responsibility to call the Building Department for the following (X) inspections:

- _____ Footing excavation prior to placing concrete.
- _____ Footing drains and foundation prior to backfill.
- _____ Prepared sub-grade prior to placing concrete floor slab.
- X _____ Sanitary sewer
- _____ Rough-in electrical, plumbing and service framing prior to installing wall board.
- X _____ Final electrical, plumbing and heating.
- _____ Final building inspection, prior to occupancy.

PERMIT & FEES

Building Permit	\$ _____
Electrical Permit	\$ <u>5.00</u>
Plumbing Permit	\$ _____
Mechanical Permit	\$ _____
Demolition Permit	\$ _____
Zoning Permit	\$ _____
Sign Permit	\$ _____
Water Tap	\$ _____
Sewer Tap	\$ _____
Temp. Elec.	\$ _____
Other	\$ _____
TOTAL FEES	\$ <u>5.00</u>
LESS FEES PAID	\$ <u>0.00</u>
BALANCE DUE	\$ _____

Permit is not valid until all fees are paid in full, and shall be void if work is not started within six months of date above.

PAID
SEP 17 1984
CITY OF NAPOLEON

INSPECTION RECORD

UNDERGROUND			ROUGH-IN &			FINAL		
Type	Date	By	Type	Date	By	Type	Date	By
PLUMBING								
Sewer Connection			Drainage, W. & Vent			Drainage, W. & Vent		
Building Sewer			Water Piping			Water Heater		
Water Piping			Condensate Lines			Backflow Prevention		
			Indirect Waste					
						FINAL APPROVAL		
ELECTRICAL								
Floor Ducts Raceways			Rough Wiring			Electric Mtr. Clearance		
Conduits & Cable			Conduits/Cable			Signs		
Grounding & Bonding			Service Panel					
			Switchboard					
			Subpanels					
			<input type="checkbox"/> Range <input type="checkbox"/> Dryer			FINAL APPROVAL		
MECHANICAL								
Refrigerant Piping			Refrigerant Piping			Duct Insulation		
Ducts/Plenums			Ducts/Plenums			Chimney(s)		
			Ventilation			Furnace(s)		
			<input type="checkbox"/> Supply <input type="checkbox"/> Exhst.			FINAL APPROVAL		
BUILDING								
Location, Set-backs, Esmt(s)			Wall Construction			Fireplace Chimney		
Excavation			Crawl Space			Attic		
Footings & Reinforcing			<input type="checkbox"/> Vent <input type="checkbox"/> Access			<input type="checkbox"/> Vent <input type="checkbox"/> Access		
Sub-soil Drain			Floor System(s)			Special Insp Reports Rec'd		
Foundation Walls			Roof System			Smoke Detector		
Floor Slab			Fire Wall(s)			Demolition (sewer cap)		
			Roof Cover Roof Drain			Building or Structure		
FINAL APPROVAL BLDG. DEPT.			Certificate of Occupancy Issued			#		

4/19/88 Nothing done